



Material Handling, Healthcare & Cleanroom Equipment



Stainless Steel Inset **CASEWORK**

Education • Research • Municipality • Laboratory

Pharmaceutical • Biotech • Cleanroom • Healthcare

Phone: 1-800-441-8440 • F: 302-653-2065 • www.eaglemhc.com

Eagle MHC manufactures a broad line of stainless steel inset casework featuring a wide variety of drawer and door configurations to meet your laboratory requirements with all casework proudly made in the U.S.A.

Our casework construction and performance characteristics are in full compliance with SEFA 8M Metal standards.

In addition to our extensive casework product line, Eagle MHC offers stainless steel countertops, custom stainless steel fabrication, laboratory sinks, workstations, shelving and other storage solutions.

Table of Contents

Adjustable Height Tables

with Pinned Legs	20
with Electronic Drive	20

Base Units - Sitting Height Cabinets

with Door/Drawer Combo	10
with Drawer Bank	9
with Full-Height Door(s)	9
with Open Front	9
Corner Bases	10
Sink Bases	10

Base Units - Standing Height Cabinets

with Door/Drawer Combo	6-7
with Drawer Bank	4-5
with Full-Height Door(s)	4
with Open Front	4
Corner Bases	8
Sink Bases	8

Base Fillers

Corner Fillers	12
Knee Space Apron Kits	11
Knee Space Panels	11
Rear Filler Panels	12
Rear Filler Scribes	12
Toe Fillers	11
Toe Scribes	11

Bench Frames

Standard	18
with Drawer(s)	19

Healthcare Storage Cabinets

Single and Double Width Units	21
Baskets and Trays	21

Laboratory Exhaust Canopies

Laboratory Exhaust Canopies	12
-----------------------------------	----

Laboratory Wall Shelves

Laboratory Wall Shelves	17
-------------------------------	----

Pegboards

Pegboards	18
-----------------	----

Stainless Steel Countertops

Stainless Steel Countertops	22-23
-----------------------------------	-------

Tall Cabinets

Framed Glass Swinging Tall Cases	17
Open Tall Cases	16
Solid Swinging Tall Cases	16

Upper Cabinets

Framed Glass Swinging Wall Cases	14
Open Wall Cases	13
Solid Swinging Wall Cases	13

Vertical Storage Cabinets

Vertical Storage Cabinets	20
---------------------------------	----

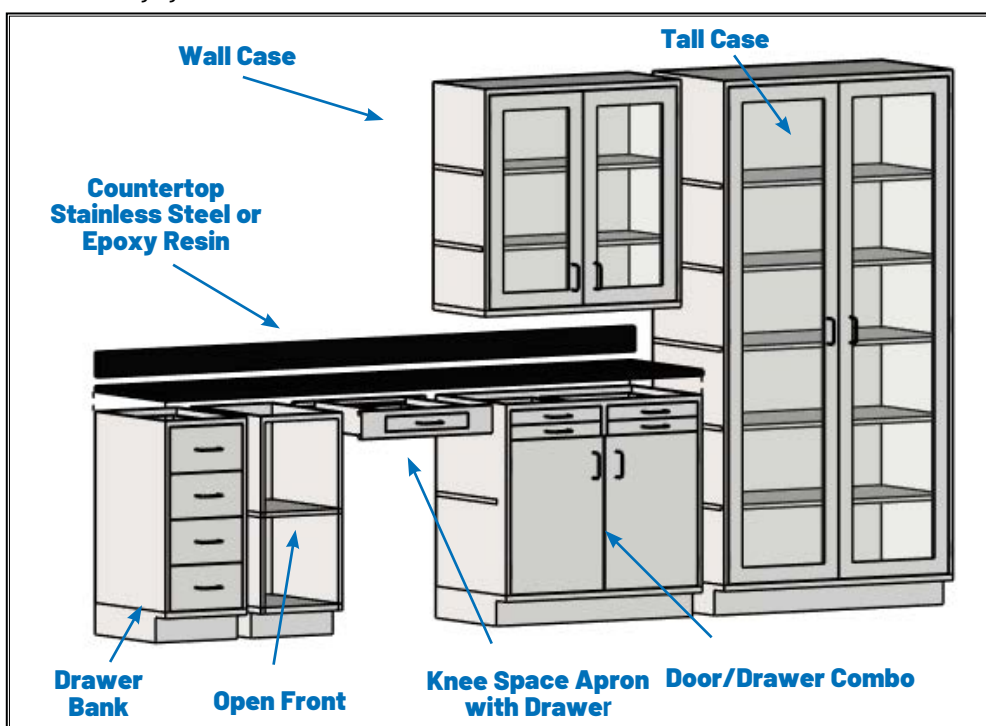

Standard Casework Construction Specifications

Eagle MHC's casework construction and performance characteristics are in full compliance with SEFA 8M Metal standards.



Click on the buttons below to download copies of our Casework General Architectural Specification, SEFA 8M Test Results - Casework and SEFA 3 Test Results - Worksurfaces.

Download
General Architectural
Specifications

Download
SEFA8 Test Results
Casework

Download
SEFA3 Test Results
Worksurfaces

Download
CAD and
REVIT Files

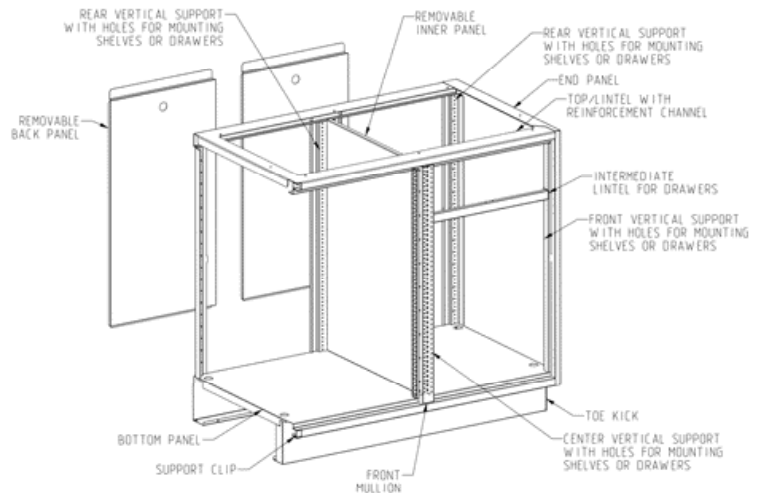

Base Units - Standing Height Cabinets

with Open Base

Download
Spec Sheet
EG03.00

FEATURES:

- Open Base with interior shelf
- Standing Height - 35" (889mm) high.
- 22" (559mm) depth.

depth		width		weight		description	model #
in	mm	in	mm	lbs.	kg		
22"	559	18"	457	74	33.6	open base	SSC-HOB-18
22"	559	24"	610	99	44.9	open base	SSC-HOB-24
22"	559	30"	762	124	56.2	open base	SSC-HOB-30
22"	559	36"	914	133	60.3	open base	SSC-HOB-36
22"	559	48"	1218	149	67.6	open base	SSC-HOB-48

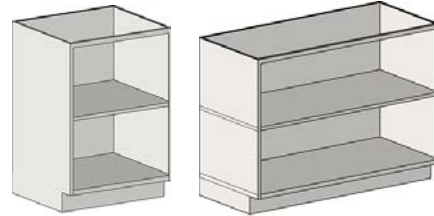

with Full-Height Door(s)

Download
Spec Sheet
EG03.00

FEATURES:

- Full-height hinged door(s) with wire style pull.
- Intermediate shelf.
- Standing Height - 35" (889mm) high.
- 22" (559mm) depth.

depth		width		weight		description	model #
in	mm	in	mm	lbs.	kg		
22"	559	18"	457	99	44.9	left swing door	SSC-HCBL-18
22"	559	18"	457	99	44.9	right swing door	SSC-HCBL-18
22"	559	24"	610	124	56.2	left swing door	SSC-HCBL-24
22"	559	24"	610	124	56.2	right swing door	SSC-HCBL-24
22"	559	30"	762	174	78.9	double doors	SSC-HCB-30
22"	559	36"	914	183	83.0	double doors	SSC-HCB-36
22"	559	48"	1219	199	90.3	double doors	SSC-HCB-48

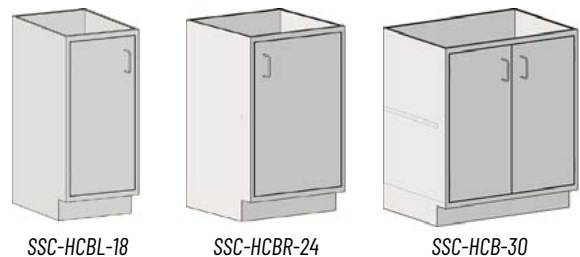

with Single-Bank Drawers

Download
Spec Sheet
EG03.01

FEATURES:

- Units with single-bank full-length drawers.
- Standing Height - 35" (889mm) high.
- 22" (559mm) depth.

Four 7" (178mm) Drawers Per Unit

depth		width		weight		no. of drawers	drawer height		model #
in	mm	in	mm	lbs.	kg		in.	mm	
22"	559	18"	457	142	64.4	4	7"	178	SSC-HDB7-18
22"	559	24"	610	167	75.7	4	7"	178	SSC-HDB7-24
22"	559	30"	762	260	117.9	4	7"	178	SSC-HDB7-30
22"	559	36"	914	269	122.0	4	7"	178	SSC-HDB7-36
22"	559	48"	1219	285	129.0	4	7"	178	SSC-HDB7-48



Three 10" (254mm) Drawers Per

depth		width		weight		no. of drawers	drawer height		model #
in	mm	in	mm	lbs.	kg		in.	mm	
22"	559	18"	457	134	60.8	3	10"	254	SSC-HDB10-18
22"	559	24"	610	159	72.1	3	10"	254	SSC-HDB10-24
22"	559	30"	762	244	110.7	3	10"	254	SSC-HDB10-30
22"	559	36"	914	253	114.8	3	10"	254	SSC-HDB10-36
22"	559	48"	1219	269	122.1	3	10"	254	SSC-HDB10-48



Base Units - Standing Height Cabinets

with Single-Bank Drawers

Download
Spec Sheet
EG03.01

- Units with single-bank full-length drawers.
- Standing Height - 35" (889mm) high.
- 22" (559mm) depth.

FEATURES:

Ten 3" (76mm) Drawers Per Unit

depth		width		weight		no. of drawers	drawer height		model #
in	mm	in	mm	lbs.	kg		in.	mm	
22"	559	18"	457	174	78.9	10	3"	76	SSC-HDB3-18
22"	559	24"	610	199	90.3	10	3"	76	SSC-HDB3-24
22"	559	30"	762	324	146.9	10	3"	76	SSC-HDB3-30
22"	559	36"	914	333	151.0	10	3"	76	SSC-HDB3-36
22"	559	48"	1219	349	158.0	10	3"	76	SSC-HDB3-48

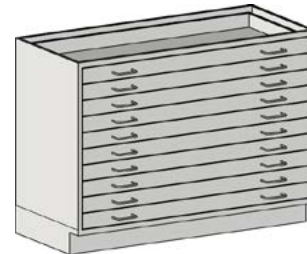

SSC-HDB3-24



SSC-HDB6-18

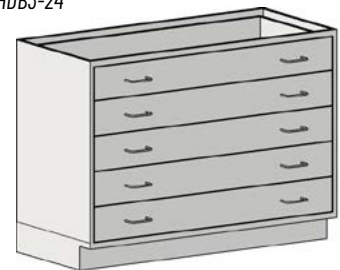

SSC-HDB6-48

Five 6" (152mm) Drawers Per Unit

depth		width		weight		no. of drawers	drawer height		model #
in	mm	in	mm	lbs.	kg		in.	mm	
22"	559	18"	457	149	67.6	5	6"	152	SSC-HDB6-18
22"	559	24"	610	174	78.9	5	6"	152	SSC-HDB6-24
22"	559	30"	762	274	124.3	5	6"	152	SSC-HDB6-30
22"	559	36"	914	283	128.4	5	6"	152	SSC-HDB6-36
22"	559	48"	1219	299	135.6	5	6"	152	SSC-HDB6-48

with Double-Bank Drawers

Download
Spec Sheet
EG03.02

- Units with double-bank of drawers.
- Standing Height - 35" (889mm) high.
- 22" (559mm) depth.

FEATURES:

Ten 6" (152mm) Drawers Per Unit

depth		width		weight		no. of drawers	drawer height		model #
in	mm	in	mm	lbs.	kg		in.	mm	
22"	559	30"	762	548	248.6	10	6"	152	SSC-HDBD6-30
22"	559	36"	914	566	256.7	10	6"	152	SSC-HDBD6-36
22"	559	48"	1219	598	271.2	10	6"	152	SSC-HDBD6-48



SSC-HDBD6-36



Eight 7" (178mm) Drawers Per Unit

depth		width		weight		no. of drawers	drawer height		model #
in	mm	in	mm	lbs.	kg		in.	mm	
22"	559	30"	762	520	235.9	8	7"	152	SSC-HDBD7-30
22"	559	36"	914	538	244.0	8	7"	152	SSC-HDBD7-36
22"	559	48"	1219	570	258.6	8	7"	152	SSC-HDBD7-48



SSC-HDBD7-48

Base Units - Standing Height Cabinets

with Door/Drawer Combination

- Units with hinged door(s) and drawer(s).
- Standing Height - 35" (889mm) high.
- 22" (559mm) depth.

FEATURES:



SSC-HDDL3-18



SSC-HDDLRT3-18

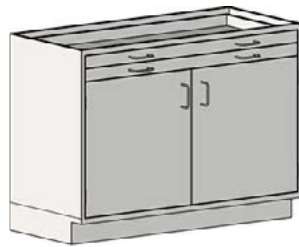

SSC-HDDT3-36

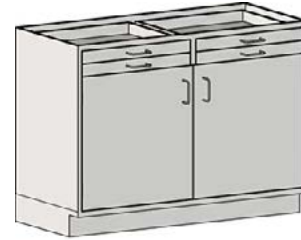

SSC-HDDT3D-36

Download
Spec Sheet
EG03.03

Units with 3" (76mm) Drawers

depth in mm	width in mm	weight lbs. kg	no. of drawers	drawer height in. mm	description	model #
22" 559	18" 457	94 42.6	2	3" 76	left swing door	SSC-HDDL3-18
22" 559	18" 457	94 42.6	2	3" 76	right swing door	SSC-HDDR3-18
22" 559	24" 610	119 53.9	2	3" 76	left swing door	SSC-HDDL3-24
22" 559	24" 610	119 53.9	2	3" 76	right swing door	SSC-HDDR3-24
22" 559	30" 762	214 97.1	2	3" 76	double doors	SSC-HDDT3-30
22" 559	36" 914	223 101.1	2	3" 76	double doors	SSC-HDDT3-36
22" 559	48" 1219	239 108.4	2	3" 76	double doors	SSC-HDDT3-48
22" 559	30" 762	224 101.6	4	3" 76	double doors	SSC-HDDT3D-30
22" 559	36" 914	233 105.7	4	3" 76	double doors	SSC-HDDT3D-36
22" 559	48" 1219	249 112.9	4	3" 76	double doors	SSC-HDDT3D-48



SSC-HDDL6-18



SSC-HDDLRT6-18

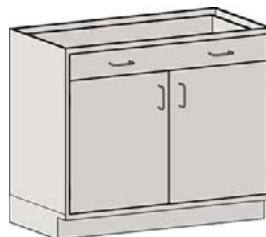

SSC-HDDT6-18

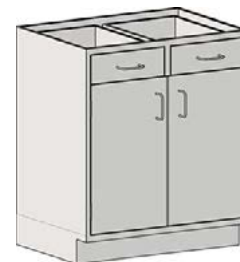

SSC-HDDT6D-30

Download
Spec Sheet
EG03.03

Units with One or Two 6" (152mm) Drawers

depth in mm	width in mm	weight lbs. kg	no. of drawers	drawer height in. mm	description	model #
22" 559	18" 457	114 51.7	1	6" 152	left swing door	SSC-HDDL6-18
22" 559	18" 457	114 51.7	1	6" 152	right swing door	SSC-HDDR6-18
22" 559	24" 610	139 63.0	1	6" 152	left swing door	SSC-HDDL6-24
22" 559	24" 610	139 63.0	1	6" 152	right swing door	SSC-HDDR6-24
22" 559	30" 762	204 92.5	1	6" 152	double doors	SSC-HDDT6-30
22" 559	36" 914	213 96.6	1	6" 152	double doors	SSC-HDDT6-36
22" 559	48" 1218	229 103.9	1	6" 152	double doors	SSC-HDDT6-48
22" 559	30" 762	214 97.1	2	6" 152	double doors	SSC-HDDT6D-30
22" 559	36" 914	223 101.2	2	6" 152	double doors	SSC-HDDT6D-36
22" 559	48" 1218	239 108.4	2	6" 152	double doors	SSC-HDDT6D-48

Base Units - Standing Height Cabinets

with Door/Drawer Combination (cont.)

[Download
Spec Sheet
EG03.04](#)

FEATURES:

- Units with door(s) and drawer(s).
- Standing Height - 35" (889mm) high.
- 22" (559mm) depth.

Units with Five 6" (152mm) Drawers

depth in mm	width in mm	weight lbs. kg	no. of drawers	drawer height in. mm	description	model #
22" 559	30" 762	209 94.8	5	6" 152	left swing door	SSC-HDDL6-30
22" 559	30" 762	209 94.8	5	6" 152	right swing door	SSC-HDDR6-30
22" 559	36" 914	218 98.9	5	6" 152	left swing door	SSC-HDDL6-36
22" 559	36" 914	218 98.9	5	6" 152	right swing door	SSC-HDDR6-36
22" 559	48" 1219	234 106.1	5	6" 152	left swing door	SSC-HDDL6-48
22" 559	48" 1219	234 106.1	5	6" 152	right swing door	SSC-HDDR6-48



SSC-HDDL6-30



SSC-HDDR6-30

[Download
Spec Sheet
EG03.04](#)

Units with Six 6" (152mm) Drawers

depth in mm	width in mm	weight lbs. kg	no. of drawers	drawer height in. mm	description	model #
22" 559	30" 762	234 106.1	6	6" 152	left swing door	SSC-HDDL6D-30
22" 559	30" 762	234 106.1	6	6" 152	right swing door	SSC-HDDR6D-30
22" 559	36" 914	243 110.2	6	6" 152	left swing door	SSC-HDDL6D-36
22" 559	36" 914	243 110.2	6	6" 152	right swing door	SSC-HDDR6D-36
22" 559	48" 1219	259 117.5	6	6" 152	left swing door	SSC-HDDL6D-48
22" 559	48" 1219	259 117.5	6	6" 152	right swing door	SSC-HDDR6D-48



SSC-HDDL6D-48

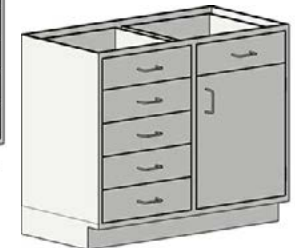

SSC-HDDR6D-48

[Download
Spec Sheet
EG03.05](#)

Units with Four 7" (178mm) Drawers

depth in mm	width in mm	weight lbs. kg	no. of drawers	drawer height in. mm	description	model #
22" 559	30" 762	202 91.6	4	7" 178	left swing door	SSC-HDDL7-30
22" 559	30" 762	202 91.6	4	7" 178	right swing door	SSC-HDDR7-30
22" 559	36" 914	211 95.7	4	7" 178	left swing door	SSC-HDDL7-36
22" 559	36" 914	211 95.7	4	7" 178	right swing door	SSC-HDDR7-36
22" 559	48" 1219	227 102.9	4	7" 178	left swing door	SSC-HDDL7-48
22" 559	48" 1219	227 102.9	4	7" 178	right swing door	SSC-HDDR7-48

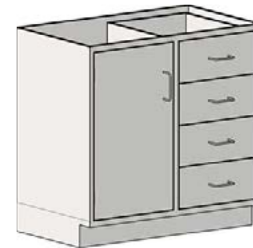

SSC-HDDL7-36



SSC-HDDR7-36

[Download
Spec Sheet
EG03.05](#)

Units with Five 7" (178mm) Drawers

depth in mm	width in mm	weight lbs. kg	no. of drawers	drawer height in. mm	description	model #
22" 559	30" 762	244 110.7	5	7" 178	left swing door	SSC-HDDL7D-30
22" 559	30" 762	244 110.7	5	7" 178	right swing door	SSC-HDDR7D-30
22" 559	36" 914	253 114.8	5	7" 178	left swing door	SSC-HDDL7D-36
22" 559	36" 914	253 114.8	5	7" 178	right swing door	SSC-HDDR7D-36
22" 559	48" 1219	269 122.0	5	7" 178	left swing door	SSC-HDDL7D-48
22" 559	48" 1219	269 122.0	5	7" 178	right swing door	SSC-HDDR7D-48



SSC-HDDL7D-30



Base Units - Standing Height Cabinets

Sink Bases

[Download Spec Sheet EG03.06](#)

FEATURES:

- Units with hinged door(s).
- Standing Height - 35" (889mm) high.
- Partial height back panel.
- 22" (559mm) depth.

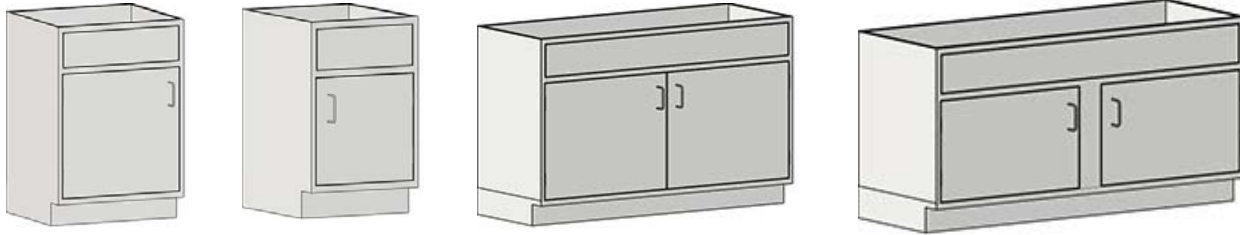

depth		width		weight		description	model #
in	mm	in	mm	lbs.	kg		
22"	559	18"	457	99	44.9	left swing door	SSC-HSBL-18
22"	559	18"	457	99	44.9	right swing door	SSC-HSBR-18
22"	559	24"	610	124	56.2	left swing door	SSC-HSBL-24
22"	559	24"	610	124	56.2	right swing door	SSC-HSBR-24
22"	559	30"	762	174	78.9	double doors	SSC-HSB-30
22"	559	36"	914	183	83.0	double doors	SSC-HSB-36
22"	559	48"	1219	199	90.2	double doors	SSC-HSB-48
22"	559	56"	1422	219	99.3	double doors	SSC-HSB-56
22"	559	58"	1473	222	100.7	double doors	SSC-HSB-58



Angled Sink Bases

[Download Spec Sheet EG03.07](#)

FEATURES:

- Removable access panel at front
- Open design at rear for plumbing
- Mounts to adjacent freestanding base units

depth		width		weight		model #
in	mm	in	mm	lbs.	kg	
22"	559	24"	610	53	24.0	SSC-HSBA-24
22"	559	30"	762	56	25.4	SSC-HSBA-30
22"	559	36"	914	62	28.2	SSC-HSBA-36
22"	559	48"	1219	75	34.0	SSC-HSBA-48



SSC-HSBS-36

Corner Base Cabinets

[Download Spec Sheet EG03.07](#)

FEATURES:

- Standing Height - 35" (889mm) high.
- Intermediate shelf adjustable on 1/2" (12mm) increments.
- 22" (559mm) depth.

depth		width*		weight		description	model #
in	mm	in	mm	lbs.	kg		
22"	559	49"	1245	142	64.4	open base	SSC-HCOB-18
22"	559	49"	1245	149	67.6	left swing door	SSC-HCCBL-18
22"	559	49"	1245	149	67.6	right swing door	SSC-HCCBR-18

* Overall end-to-end dimension.

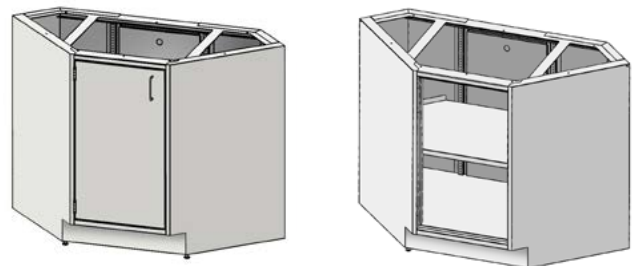

Base Units - Sitting Height Cabinets

with Open Base

Download
Spec Sheet
EG03.10

depth		width		weight		description	model #
in	mm	in	mm	lbs.	kg		
22"	559	18"	457	72	32.7	open base	SSC-SOB-18
22"	914	24"	610	97	44.0	open base	SSC-SOB-24
22"	914	30"	610	122	55.3	open base	SSC-SOB-30
22"	914	36"	610	131	59.4	open base	SSC-SOB-36
22"	914	48"	610	147	66.7	open base	SSC-SOB-48

FEATURES:

- Open Base with interior shelf
- Sitting Height - 29 $\frac{1}{8}$ " (740mm) high.
- 22" (559mm) depth.

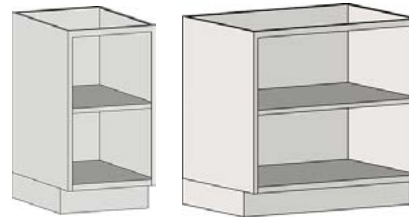

with Full Height Door(s)

Download
Spec Sheet
EG03.10

depth		width		weight		description	model #
in	mm	in	mm	lbs.	kg		
22"	559	18"	457	97	44.0	left swing door	SSC-SCBL-18
22"	914	18"	457	97	44.0	right swing door	SSC-SCBR-18
22"	914	24"	610	122	55.3	left swing door	SSC-SCBL-24
22"	914	24"	610	122	55.3	right swing door	SSC-SCBR-24
22"	914	30"	762	172	78.0	double doors	SSC-SCB-30
22"	914	36"	914	181	82.1	double doors	SSC-SCB-36
22"	914	48"	1219	197	89.4	double doors	SSC-SCB-48

FEATURES:

- Full height door with interior shelf
- Sitting Height - 29 $\frac{1}{8}$ " (740mm) high.
- 22" (559mm) depth.

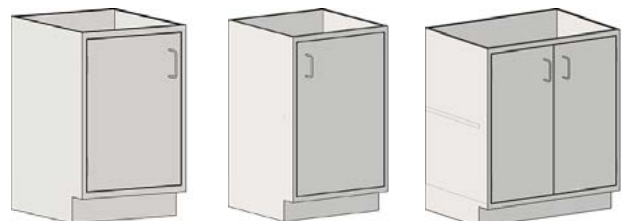

SSC-HCBL-18

SSC-HCBR-24

SSC-HCB-30



with Drawers

Download
Spec Sheet
EG03.11

FEATURES:

- Units with single-bank full-length drawers.
- Sitting Height - 29 $\frac{1}{8}$ " (740mm) high.
- 22" (559mm) depth.

Two 12" (305mm) Drawers Per

depth		width		weight		no. of drawers	drawer height		model #
in	mm	in	mm	lbs.	kg		in.	mm	
22"	559	18"	457	112	50.8	2	12"	305	SSC-SDB12-18
22"	559	24"	610	137	62.1	2	12"	305	SSC-SDB12-24



SSC-SDB12-18



SSC-SDB6-18

Four 6" (152mm) Drawers Per Unit

depth		width		weight		no. of drawers	drawer height		model #
in	mm	in	mm	lbs.	kg		in.	mm	
22"	559	18"	457	132	59.9	4	6"	152	SSC-SDB6-18
22"	559	24"	610	157	71.2	4	6"	152	SSC-SDB6-24

Base Units - Sitting Height Cabinets

with Door/Drawer Combination

[Download Spec Sheet EG03.12](#)

FEATURES:

- Units with door(s) and drawer(s).
- Sitting Height - 29 1/2" (740mm) high.
- 22" (559mm) depth.

Units with 3" (76mm) Drawers

depth in mm	width in mm	weight lbs. kg	no. of drawers	drawer height in. mm	description	model #
22" 559	18" 457	117 53.1	2	3" 152	left swing door	SSC-SDDL3-18
22" 559	18" 457	117 53.1	2	3" 152	right swing door	SSC-SDDRT3-18
22" 559	24" 610	142 64.4	2	3" 152	left swing door	SSC-SDDL3-24
22" 559	24" 610	142 64.4	2	3" 152	right swing door	SSC-SDDRT3-24



SSC-SDDL3-24



SSC-SDDRT3-24

Units with 6" (152mm) Drawer

depth in mm	width in mm	weight lbs. kg	no. of drawers	drawer height in. mm	description	model #
22" 559	18" 457	112 50.8	1	6" 152	left swing door	SSC-SDDL6-18
22" 914	18" 457	112 50.8	1	6" 152	right swing door	SSC-SDDRT6-18
22" 914	24" 457	137 62.1	1	6" 152	left swing door	SSC-SDDL6-24
22" 914	24" 610	137 62.1	1	6" 152	right swing door	SSC-SDDRT6-24



SSC-SDDL6-18



SSC-SDDRT6-18

Sink Bases

[Download Spec Sheet EG03.13](#)



depth in mm	width in mm	weight lbs. kg	description	model #
22" 559	18" 457	97 44.0	left swing door	SSC-SSBL-18
22" 914	18" 457	97 44.0	right swing door	SSC-SSBR-18
22" 914	24" 610	122 55.3	left swing door	SSC-SSBL-24
22" 914	24" 610	122 55.3	right swing door	SSC-SSBR-24
22" 914	30" 762	172 78.0	double doors	SSC-SSB-30
22" 914	36" 914	181 82.1	double doors	SSC-SSB-36
22" 914	48" 1219	197 89.4	double doors	SSC-SSB-48
22" 559	56 1422	217 98.4	double doors	SSC-SSB-56
22" 559	58 1473	220 99.8	double doors	SSC-SSB-58

FEATURES:

- Units with hinged door(s).
- Sitting Height - 29 1/2" (740mm) high.
- Partial height back panel.
- 22" (559mm) depth.



SSC-SSBL-24



SSC-SSB-56

Angled Sink Bases

[Download Spec Sheet EG03.13](#)

depth in mm	width in mm	weight lbs. kg	model #
22" 559	24" 610	49 22.2	SSC-SSBA-24
22" 559	30" 762	52 23.6	SSC-SSBA-30
22" 559	36" 914	56 25.4	SSC-SSBA-36
22" 559	48" 1219	65 29.5	SSC-SSBA-48



SSC-SSBA-18

FEATURES:

- Removable access panel at front
- Open design at rear for plumbing
- Mounts to adjacent freestanding base units

FEATURES:

- Sitting Height - 29 1/2" (740mm) high.
- Intermediate shelf adjustable on 1/2" (12mm) increments.
- 22" (559mm) depth.

Corner Base Cabinets

* Overall end-to-end dimension.

[Download Spec Sheet EG03.14](#)

depth in mm	width* in mm	weight lbs. kg	description	model #
22" 559	49" 1245	142 64.4	open base	SSC-SCOB-18
22" 559	49" 1245	149 67.6	left swing door	SSC-SCCBL-18
22" 559	49" 1245	149 67.6	right swing door	SSC-SCCB-18

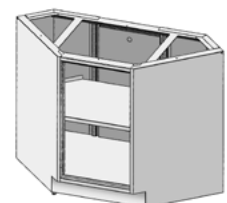

Base Fillers

Knee Space Apron Kits

Download
Spec Sheet
EG03.20

depth		width		without Drawer		w/One 3" Drawer			
in	mm	in.	mm	lbs.	kg	lbs.	kg		
model #		model #		model #		model #			
22"	559	24"	610	32	14.5	SSC-KAK-24	46	20.8	SSC-KAK1D-24
22"	559	30"	762	35	15.9	SSC-KAK-30	49	22.2	SSC-KAK1D-30
22"	559	36"	914	38	17.2	SSC-KAK-36	52	23.6	SSC-KAK1D-36
22"	559	48"	1219	41	18.5	SSC-KAK-48	55	25.0	SSC-KAK1D-48

FEATURES:

- Ships knocked down.
- Mounts to adjacent freestanding bases.
- Kits with Drawer feature 3" drawer assembly with wire pull.

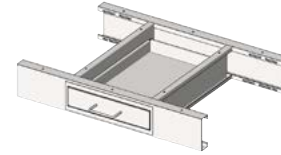

Knee-Space Filler Panels

Download
Spec Sheet
EG03.20

width		weight		35" Standing Height		29" Sitting Height	
in	mm	lbs.	kg	lbs.	kg	lbs.	kg
model #		model #		model #		model #	
24"	610	20.0	9.1	SSC-HKPL-24	17.0	7.7	SSC-SKPL-24
30"	762	22.0	10.1	SSC-HKPL-30	18.5	8.6	SSC-SKPL-30
36"	914	24.0	10.9	SSC-HKPL-36	20.0	9.0	SSC-SKPL-36

FEATURES:

- 29" (740mm) Sitting or 35" (889mm) Standing Height.
- For use with no apron above.



Toe Fillers

Download
Spec Sheet
EG03.20

depth		width		weight		35" Standing Height		29" Sitting Height		84" Tall Height		
in	mm	in.	mm	lbs.	kg	lbs.	kg	lbs.	kg	lbs.	kg	
model #		model #		model #		model #		model #		model #		
1"	25	3"	76	1.0	0.5	SSC-HTF-3	0.9	0.5	SSC-STF-3	2.4	1.1	SSC-TTF-3
1"	25	6"	152	2.0	0.9	SSC-HTF-6	1.7	0.8	SSC-STF-6	4.8	2.2	SSC-TTF-6
1"	25	12"	305	3.0	1.4	SSC-HTF-12	2.5	1.1	SSC-STF-12	9.6	4.4	SSC-TTF-12

FEATURES:

- 29" (740mm) Sitting, 35" (889mm) Standing Height, or 84" (2134mm) Tall Height.



Toe Scribes

Download
Spec Sheet
EG03.20

depth		width		weight		35" Standing Height		29" Sitting Height		84" Tall Height			
in	mm	in.	mm	lbs.	kg	lbs.	kg	lbs.	kg	lbs.	kg		
orientation		orientation		model #		model #		model #		model #			
1"	25	1"	25	left	1.0	0.5	SSC-HTSL-1	0.9	0.5	SSC-STSL-1	2.4	1.1	SSC-TTSL-1
1"	25	2"	51	left	1.5	0.7	SSC-HTSL-2	1.0	0.5	SSC-STSL-2	3.6	1.6	SSC-TTSL-2
1"	25	3"	76	left	2.0	0.9	SSC-HTSL-3	1.3	0.6	SSC-STSL-3	4.8	2.2	SSC-TTSL-3
1"	25	1"	25	right	1.0	0.5	SSC-HTSR-1	0.9	0.5	SSC-STSR-1	2.4	1.1	SSC-TTSR-1
1"	25	2"	51	right	1.5	0.7	SSC-HTSR-2	1.0	0.5	SSC-STSR-2	3.6	1.6	SSC-TTSR-2
1"	25	3"	76	right	2.0	0.9	SSC-HTSR-3	1.3	0.6	SSC-STSR-3	4.8	2.2	SSC-TTSR-3

FEATURES:

- 29" (740mm) Sitting, 35" (889mm) Standing Height, or 84" (2134mm) Tall Height.



Base Fillers

Rear Filler Panels

Download
Spec Sheet
EG03.21

FEATURES:

- 29½" (740mm) Sitting, 35" (889mm) Standing Height, or 84" (2134mm) Tall Height.

35" Standing Height					29½" Sitting Height						
depth		width		weight		model #		weight		model #	
in	mm	in.	mm	lbs.	kg	lbs.	kg	lbs.	kg	lbs.	kg
3"	76	6"	152	4.0	1.8	SSC-HRFP-6		3.0	1.4	SSC-SRFP-6	
3"	76	12"	305	5.0	2.3	SSC-HRFP-12		4.0	1.8	SSC-SRFP-12	
								9.6	4.4	SSC-TRFP-6	
								14.4	6.5	SSC-TRFP-12	



Rear Filler Scribes

Download
Spec Sheet
EG03.21

FEATURES:

- 29½" (740mm) Sitting, 35" (889mm) Standing Height, or 84" (2134mm) Tall Height.

35" Standing Height					29½" Sitting Height					84" Tall Height							
depth		width		weight		orientation		model #		weight		model #		weight		model #	
in	mm	in.	mm	lbs.	kg	lbs.	kg	lbs.	kg	lbs.	kg	lbs.	kg	lbs.	kg	lbs.	kg
1"	25	1"	25	1.2	0.5	SSC-HRFSL-1	left	1.0	0.5	SSC-SRFSL-1	2.9	1.3	SSC-TRFSL-1				
1"	25	2"	51	1.4	0.6	SSC-HRFSL-2	left	1.0	0.5	SSC-SRFSL-2	3.4	1.5	SSC-TRFSL-2				
1"	25	3"	76	2.2	1.0	SSC-HRFSL-3	left	2.0	0.9	SSC-SRFSL-3	5.3	2.4	SSC-TRFSL-3				
1"	25	6"	152	3.3	1.5	SSC-HRFSL-6	left	3.0	1.4	SSC-SRFSL-6	7.9	3.6	SSC-TRFSL-6				
1"	25	1"	25	1.2	0.5	SSC-HRFSR-1	right	1.0	0.5	SSC-SRFSR-1	2.9	1.3	SSC-TRFSR-1				
1"	25	2"	51	1.4	0.6	SSC-HRFSR-2	right	1.0	0.5	SSC-SRFSR-2	3.4	1.5	SSC-TRFSR-2				
1"	25	3"	76	2.2	1.0	SSC-HRFSR-3	right	2.0	0.9	SSC-SRFSR-3	5.3	2.4	SSC-TRFSR-3				
1"	25	6"	152	3.3	1.5	SSC-HRFSR-6	right	3.0	1.4	SSC-SRFSR-6	7.9	3.6	SSC-TRFSR-6				

Corner Fillers

Download
Spec Sheet
EG03.21

FEATURES:

- 29½" (740mm) Sitting, 35" (889mm) Standing Height, or 84" (2134mm) Tall Height.

35" Standing Height					29½" Sitting Height					84" Tall Height					
depth		width		weight		model #		weight		model #		weight		model #	
in	mm	in.	mm	lbs.	kg	lbs.	kg	lbs.	kg	lbs.	kg	lbs.	kg	lbs.	kg
1"	25	3"	76	2.0	0.9	SSC-HCF-3		1.5	0.7	SSC-SCF-3		4.8	2.2	SSC-TCF-3	
1"	25	6"	152	3.0	1.4	SSC-HCF-6		2.5	1.1	SSC-SCF-6		7.2	3.3	SSC-TCF-6	

Vertical Storage Cabinets

Note: Custom sizes, glass doors, locks, and additional shelves available upon request. **Please contact Factory for pricing on these options.**



vertical storage cabinet with flat top

Download
Spec Sheet
EG04.11

FEATURES:

- Four (4) adjustable intermediate shelves.
- Stationary "-SLG" units feature stainless steel legs with 1" (25mm) adjustable bullet feet.
- Mobile "-CPB" units include 4" (102mm)-diameter swivel/brake casters with poly tread.



with Flat Top								with Sloped Top					
depth		width		height		weight		height		weight		model #	
in	mm	in.	mm	in.	mm	lbs.	kg	in.	mm	lbs.	kg	in.	mm
18"	457	36"	914	stationary	72"	1829	416 188.7	SSC-TSC-1836	77"	1956	419 190.0	SSC-TSCST-1836	
18"	457	48"	1219	stationary	72"	1829	490 222.3	SSC-TSC-1848	77"	1956	495 224.5	SSC-TSCST-1848	
24"	610	36"	914	stationary	72"	1829	458 207.7	SSC-TSC-2436	77"	1956	461 209.1	SSC-TSCST-2436	
24"	610	48"	1219	stationary	72"	1829	539 244.5	SSC-TSC-2448	77"	1956	545 247.2	SSC-TSCST-2448	
24"	610	36"	914	mobile	72"	1829	462 209.6	SSC-TSC-2436-CPB	78"	1981	465 210.9	SSC-TSCST-2436-CPB	
24"	610	48"	1219	mobile	72"	1829	543 246.3	SSC-TSC-2448-CPB	78"	1981	549 249.0	SSC-TSCST-2448-CPB	

Upper Cabinets

Open Wall Cases

Download
Spec Sheet
EG03.30

- FEATURES:**
- Open front.
 - Two adjustable shelves.
 - 31" (787mm) height.
 - 13" (330mm) or 16" (406mm) depth.

		with Flat Top			with Sloped Top			
depth	width	weight		model #	weight	model #		
in	mm	in	mm	lbs.	kg	in	mm	
13"	330	18"	457	117	53.1	SSC-WCO-1318	132 59.9	SSC-WCOST-1318
13	330	24	610	123	55.8	SSC-WCO-1324	138 62.6	SSC-WCOST-1324
13	330	30	762	129	58.5	SSC-WCO-1330	144 65.3	SSC-WCOST-1330
13	330	36	914	141	63.9	SSC-WCO-1336	156 70.7	SSC-WCOST-1336
13	330	48	1219	165	74.8	SSC-WCO-1348	180 81.6	SSC-WCOST-1348
16	406	18	457	122	55.3	SSC-WCO-1618	137 62.1	SSC-WCOST-1618
16	406	24	610	128	58.0	SSC-WCO-1624	143 64.9	SSC-WCOST-1624
16	406	30	762	134	60.8	SSC-WCO-1630	149 67.6	SSC-WCOST-1630
16	406	36	914	146	66.2	SSC-WCO-1636	161 73.0	SSC-WCOST-1636
16	406	48	1219	170	77.1	SSC-WCO-1648	185 83.9	SSC-WCOST-1648

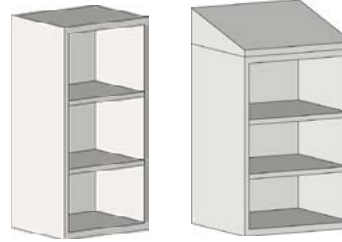

Solid Swinging Wall Cases

Download
Spec Sheet
EG03.31

- FEATURES:**
- Full height solid hinged door(s).
 - Two adjustable shelves.
 - 31" (787mm) height.
 - 13" (330mm) or 16" (406mm) depth.

with Flat Top

depth	width	weight		description	model #		
in	mm	in	mm			lbs.	kg
13"	330	18"	457	136	61.7	left swing door	SSC-WCHL-1318
13"	330	18"	457	136	61.7	right swing door	SSC-WCHR-1318
13"	330	24"	610	142	64.4	left swing door	SSC-WCHL-1324
13"	330	24"	610	142	64.4	right swing door	SSC-WCHR-1324
13"	330	30"	762	154	69.8	double doors	SSC-WCH-1330
13"	330	36"	914	172	78.0	double doors	SSC-WCH-1336
13"	330	48"	1219	208	94.3	double doors	SSC-WCH-1348
16"	406	18"	457	142	64.4	left swing door	SSC-WCHL-1618
16"	406	18"	457	142	64.4	right swing door	SSC-WCHR-1618
16"	406	24"	610	148	67.1	left swing door	SSC-WCHL-1624
16"	406	24"	610	148	67.1	right swing door	SSC-WCHR-1624
16"	406	30"	762	160	72.6	double doors	SSC-WCH-1630
16"	406	36"	914	166	75.3	double doors	SSC-WCH-1636
16"	406	48"	1219	214	97.1	double doors	SSC-WCH-1648



SSC-WCHL-1324



SSC-WCHR-1324

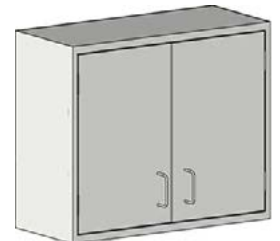

SSC-WCH-1348

with Sloped Top

depth	width	weight		description	model #		
in	mm	in	mm			lbs.	kg
13"	330	18"	457	156	70.7	left swing door	SSC-WCHLST-1318
13"	330	18"	457	156	70.7	right swing door	SSC-WCHRST-1318
13"	330	24"	610	162	73.5	left swing door	SSC-WCHLST-1324
13"	330	24"	610	162	73.5	right swing door	SSC-WCHRST-1324
13"	330	30"	762	174	78.9	double doors	SSC-WCHST-1330
13"	330	36"	914	192	87.1	double doors	SSC-WCHST-1336
13"	330	48"	1219	228	103.4	double doors	SSC-WCHST-1348
16"	406	18"	457	162	73.5	left swing door	SSC-WCHLST-1618
16"	406	18"	457	162	73.5	right swing door	SSC-WCHRST-1618
16"	406	24"	610	168	76.2	left swing door	SSC-WCHLST-1624
16"	406	24"	610	168	76.2	right swing door	SSC-WCHRST-1624
16"	406	30"	762	180	81.6	double doors	SSC-WCHST-1630
16"	406	36"	914	186	84.4	double doors	SSC-WCHST-1636
16"	406	48"	1219	234	106.1	double doors	SSC-WCHST-1648

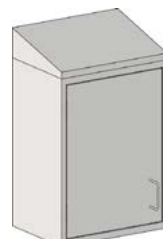

SSC-WCHLST-1324



SSC-WCHRST-1324

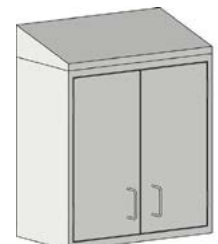

SSC-WCHST-1330

Upper Cabinets

Framed Glass Swinging Wall Cases

[Download
Spec Sheet
EG03.32](#)

with Flat Top

depth		width		weight		description	model #
in	mm	in	mm	lbs.	kg		
13"	330	18"	457	166	75.3	left swing door	SSC-WCGHL-1318
13"	330	18"	457	166	75.3	right swing door	SSC-WCGHR-1318
13"	330	24"	610	172	78.0	left swing door	SSC-WCGHL-1324
13"	330	24"	610	172	78.0	right swing door	SSC-WCGHR-1324
13"	330	30"	762	184	83.4	double doors	SSC-WCGH-1330
13"	330	36"	914	184	83.4	double doors	SSC-WCGH-1336
13"	330	48"	1219	202	91.6	double doors	SSC-WCGH-1348
16"	406	18"	457	172	78.0	left swing door	SSC-WCGHL-1618
16"	406	18"	457	172	78.0	right swing door	SSC-WCGHR-1618
16"	406	24"	610	178	80.7	left swing door	SSC-WCGHL-1624
16"	406	24"	610	178	80.7	right swing door	SSC-WCGHR-1624
16"	406	30"	762	160	72.6	double doors	SSC-WCGH-1630
16"	406	36"	914	166	75.3	double doors	SSC-WCGH-1636
16"	406	48"	1219	214	97.1	double doors	SSC-WCGH-1648

[Download
Spec Sheet
EG03.32](#)

with Sloped Top

depth		width		weight		description	model #
in	mm	in	mm	lbs.	kg		
13"	330	18"	457	186	84.4	left swing door	SSC-WCGHLST-1318
13"	330	18"	457	186	84.4	right swing door	SSC-WCGHRST-1318
13"	330	24"	610	192	87.1	left swing door	SSC-WCGHLST-1324
13"	330	24"	610	192	87.1	right swing door	SSC-WCGHRST-1324
13"	330	30"	762	244	110.7	double doors	SSC-WCGHST-1330
13"	330	36"	914	222	100.7	double doors	SSC-WCGHST-1336
13"	330	48"	1219	158	71.7	double doors	SSC-WCGHST-1348
16"	406	18"	457	192	87.1	left swing door	SSC-WCGHLST-1618
16"	406	18"	457	192	87.1	right swing door	SSC-WCGHRST-1618
16"	406	24"	610	198	89.8	left swing door	SSC-WCGHLST-1624
16"	406	24"	610	198	89.8	right swing door	SSC-WCGHRST-1624
16"	406	30"	762	210	95.2	double doors	SSC-WCGHST-1630
16"	406	36"	914	216	98.0	double doors	SSC-WCGHST-1636
16"	406	48"	1219	264	119.7	double doors	SSC-WCGHST-1648

- Full height hinged door(s) with framed glass.
- Two adjustable shelves.
- 31" (787mm) height.
- 13" (330mm) or 16" (406mm) depth.

FEATURES:



SSC-WCGHL-1324



SSC-WCGHR-1324

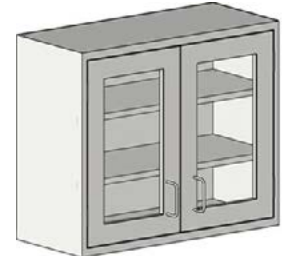

SSC-WCGH-1348



SSC-WCGHLST-1324



SSC-WCGHRST-1324

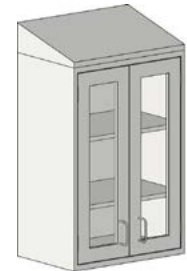

SSC-WCGHST-1630

- Open front or solid hinged left or right door.
- Two adjustable shelves.
- 31" (787mm) height.
- 13" (330mm) or 16" (406mm) depth.

FEATURES:

Corner Cases

[Download
Spec Sheet
EG03.33](#)

depth		width*		weight		description	model #
in	mm	in	mm	lbs.	kg		
13"	330	36 $\frac{3}{8}$ "	924	120	54.4	open front	SSC-WCCO-1318
13"	330	18"	457	126	57.2	left swing door	SSC-WCCHL-1318
13"	330	18"	457	126	57.2	right swing door	SSC-WCCHR-1318
16"	406	18"	457	135	61.2	open front	SSC-WCCO-1618
16"	406	18"	457	141	64.0	left swing door	SSC-WCCHL-1618
16"	406	18"	457	141	64.0	right swing door	SSC-WCCHR-1618

* Overall end-to-end dimension.



SSC-WCCHR-1318

Tall Cabinets

Open Tall Cases

Download
Spec Sheet
EG03.40

FEATURES:

- Open front.
- Five adjustable shelves.
- 84" (2134mm) height.
- 18" (457mm) or 24" (610mm) depth.

depth		width		weight		with Flat Top		with Sloped Top	
in	mm	in	mm	lbs.	kg	model #	weight	weight	model #
							lbs.	kg	
18"	457	24"	610	263	119.3	SSC-TOB-1824	283	128.3	SSC-TOBST-1824
18"	457	30"	762	293	132.9	SSC-TOB-1830	313	142.0	SSC-TOBST-1830
18"	457	36"	914	301	136.5	SSC-TOB-1836	321	145.6	SSC-TOBST-1836
18"	457	48"	1219	331	150.1	SSC-TOB-1848	351	159.2	SSC-TOBST-1848
24"	610	24"	610	338	153.3	SSC-TOB-2424	358	162.4	SSC-TOBST-2424
24"	610	30"	762	368	166.9	SSC-TOB-2430	388	176.0	SSC-TOBST-2430
24"	610	36"	914	413	187.3	SSC-TOB-2436	433	196.4	SSC-TOBST-2436
24"	610	48"	1219	443	200.9	SSC-TOB-2448	463	210.0	SSC-TOBST-2448

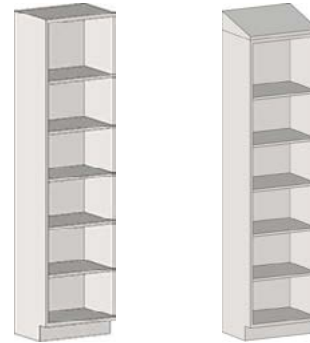

Solid Swinging Tall Cases

Download
Spec Sheet
EG03.41

FEATURES:

- Full height solid hinged door(s).
- Five adjustable shelves.
- 84" (2134mm) height.
- 18" (457mm) or 24" (610mm) depth.

with Flat Top

depth		width		weight		description	model #
in	mm	in	mm	lbs.	kg		
18"	457	24"	610	343	64.4	left swing door	SSC-TCBL-1824
18"	457	24"	610	343	64.4	right swing door	SSC-TCBR-1824
18"	457	30"	762	381	69.8	double doors	SSC-TCB-1830
18"	457	36"	914	413	78.0	double doors	SSC-TCB-1836
18"	457	48"	1219	418	94.3	double doors	SSC-TCB-1848
24"	610	24"	610	373	67.1	left swing door	SSC-TCBL-2424
24"	610	24"	610	373	67.1	right swing door	SSC-TCBR-2424
24"	610	30"	762	448	72.6	double doors	SSC-TCB-2430
24"	610	36"	914	493	75.3	double doors	SSC-TCB-2436
24"	610	48"	1219	523	97.1	double doors	SSC-TCB-2448

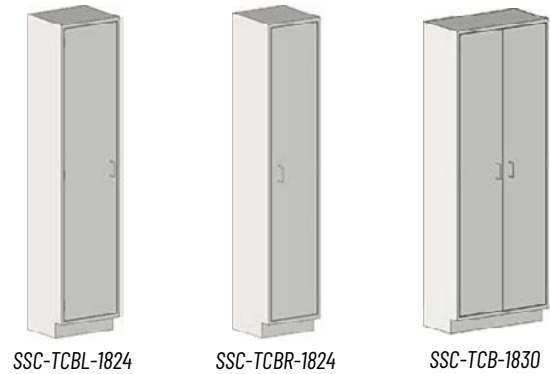

with Sloped Top

depth		width		weight		description	model #
in	mm	in	mm	lbs.	kg		
18"	457	24"	610	363	164.6	left swing door	SSC-TCBSTL-1824
18"	457	24"	610	363	164.6	right swing door	SSC-TCBSTR-1824
18"	457	30"	762	401	181.9	double doors	SSC-TCBST-1830
18"	457	36"	914	431	195.5	double doors	SSC-TCBST-1836
18"	457	48"	1219	438	198.6	double doors	SSC-TCBST-1848
24"	610	24"	610	393	178.2	left swing door	SSC-TCBSTL-2424
24"	610	24"	610	393	178.2	right swing door	SSC-TCBSTR-2424
24"	610	30"	762	468	212.2	double doors	SSC-TCBST-2430
24"	610	36"	914	513	232.7	double doors	SSC-TCBST-2436
24"	610	48"	1219	543	246.3	double doors	SSC-TCBST-2448

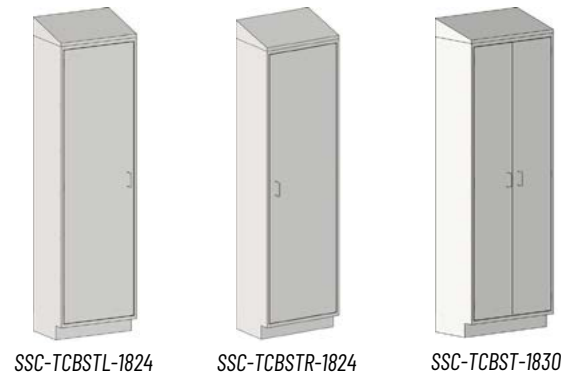

Tall Cabinets

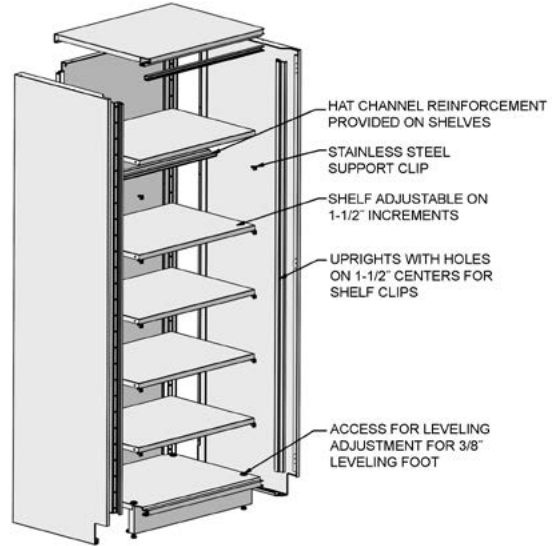

Framed Glass Swinging Tall Cases

Download
 Spec Sheet
 EG03.42

with Flat Top

depth	width	weight					
in	mm	in	mm	lbs.	kg	description	
						model #	
18"	457	24"	610	443	200.9	left swing door	SSC-TCBGL-1824
18"	457	24"	610	443	200.9	right swing door	SSC-TCBGR-1824
18"	457	30"	762	481	218.1	double doors	SSC-TCBG-1830
18"	457	36"	914	481	218.1	double doors	SSC-TCBG-1836
18"	457	48"	1219	518	234.9	double doors	SSC-TCBG-1848
24"	610	24"	610	473	214.5	left swing door	SSC-TCBGL-2424
24"	610	24"	610	473	214.5	right swing door	SSC-TCBGR-2424
24"	610	30"	762	548	248.5	double doors	SSC-TCBG-2430
24"	610	36"	914	593	268.9	double doors	SSC-TCBG-2436
24"	610	48"	1219	623	282.5	double doors	SSC-TCBG-2448

with Sloped Top

depth	width	weight					
in	mm	in	mm	lbs.	kg	description	
						model #	
18"	457	24"	610	463	210.0	left swing door	SSC-TCBGLST-1824
18"	457	24"	610	463	210.0	right swing door	SSC-TCBGRST-1824
18"	457	30"	762	501	227.2	double doors	SSC-TCBGST-1830
18"	457	36"	914	531	240.8	double doors	SSC-TCBGST-1836
18"	457	48"	1219	538	244.0	double doors	SSC-TCBGST-1848
24"	610	24"	610	493	223.6	left swing door	SSC-TCBGLST-2424
24"	610	24"	610	493	223.6	right swing door	SSC-TCBGRST-2424
24"	610	30"	762	568	257.6	double doors	SSC-TCBGST-2430
24"	610	36"	914	613	278.0	double doors	SSC-TCBGST-2436
24"	610	48"	1219	643	291.6	double doors	SSC-TCBGST-2448

- Full height hinged door(s) with framed glass.
- Five adjustable shelves.
- 84" (2134mm) height.
- 18" (457mm) or 24" (610mm) depth.

FEATURES:



SSC-TCBGL-1818

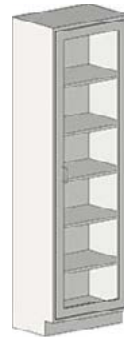

SSC-TCBGR-1824

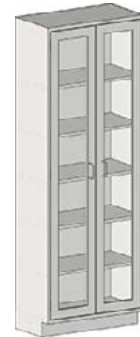

SSC-TCBG-1830



SSC-TCBGLST-1824



SSC-TCBGRST-1824



SSC-TCBGST-1830

Laboratory Exhaust Canopies



Download
Spec Sheet
EG03.85

- FEATURES:**
- Exhaust canopies are available in 30" and 36" depths, and widths ranging from 36" to 96".

depth		width		overall height *		Island	Wall
in.	mm	in.	mm	in.	mm	model #	model #
30"	762	36"	914	19"	483	SSC-IEC-3630-18	SSC-WEC-3630-18
30"	762	48"	1219	19"	483	SSC-IEC-4830-18	SSC-WEC-4830-18
30"	762	60"	1524	19"	483	SSC-IEC-6030-18	SSC-WEC-6030-18
30"	762	72"	1829	19"	483	SSC-IEC-7230-18	SSC-WEC-7230-18
30"	762	84"	2133	19"	483	SSC-IEC-8430-18	SSC-WEC-8430-18
30"	762	96"	2438	19"	483	SSC-IEC-9630-18	SSC-WEC-9630-18
36"	914	36"	914	19"	483	SSC-IEC-3636-18	SSC-WEC-3636-18
36"	914	48"	1219	19"	483	SSC-IEC-4836-18	SSC-WEC-4836-18
36"	914	60"	1524	19"	483	SSC-IEC-6036-18	SSC-WEC-6036-18
36"	914	72"	1829	19"	483	SSC-IEC-7236-18	SSC-WEC-7236-18
36"	914	84"	2133	19"	483	SSC-IEC-8436-18	SSC-WEC-8436-18
36"	914	96"	2438	19"	483	SSC-IEC-9636-18	SSC-WEC-9636-18



* Height includes duct collar.

Casework Configurator

Check out MHC's new Stainless Steel Casework Configurator. Create a lineup for your new or existing space today!

View
Casework
Configurator

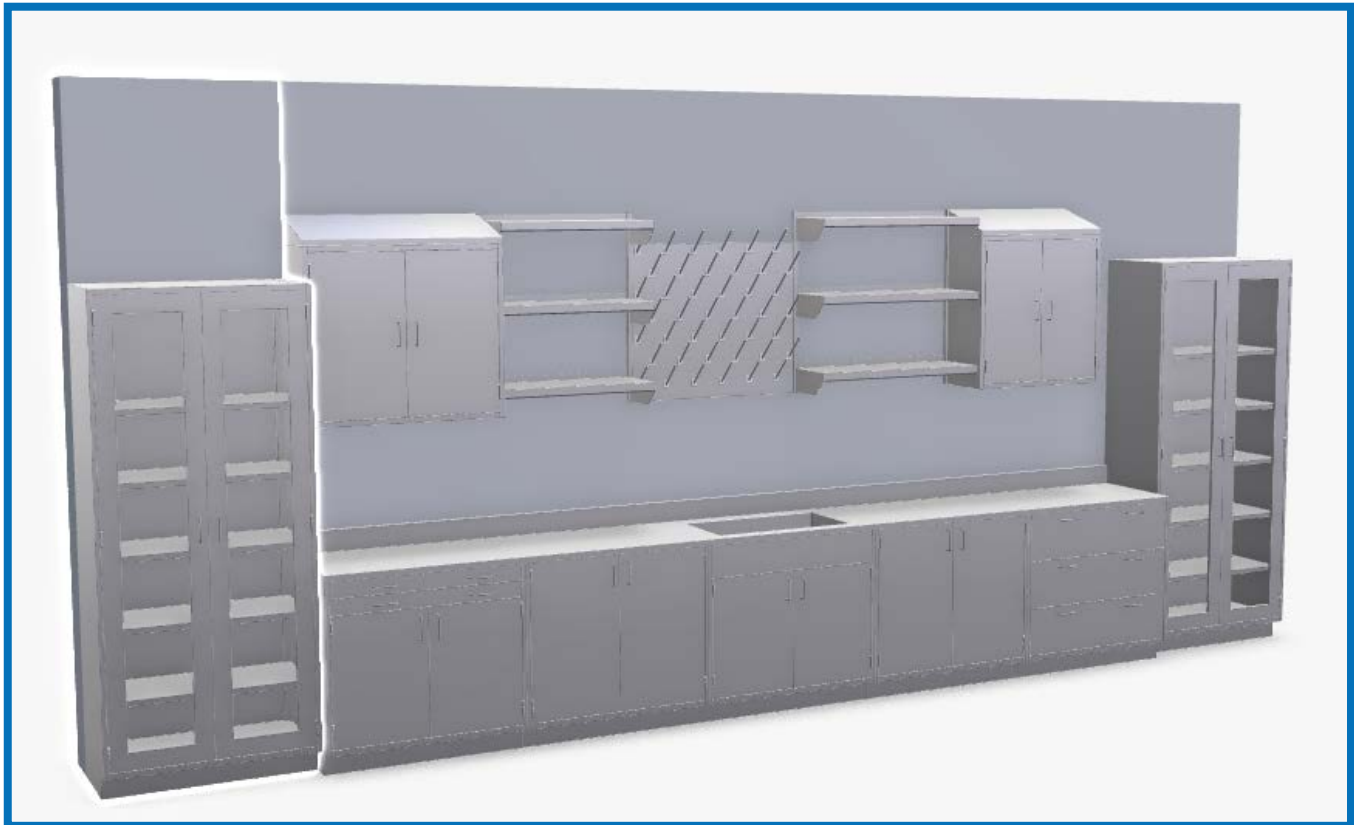

Laboratory Wall Shelves



**Download
Spec Sheet
EG03.81**

FEATURES:

- 16 gauge stainless steel shelves, with center hat channel and 1/4" rear upturn
- Adjustable on 1/2" increments
- 36" tall, 1" square tubular uprights
- 150-lb max weight capacity

WITH UPTURNED BOOKENDS COMPONENTS

shelf depth		shelf length		overall length		weight lbs. kg	STANDARD SHELVES	WITH WIRE LEDGE	SINGLE SHELF	SINGLE SHELF WITH WIRE
in	mm	in	mm	in	mm		model #	model #	model #	model #
12"	305	30"	762	31"	787	38 17.2	LS1230-36-3	LS1230-36-3L	LS1230	LS1230-L
12"	305	36"	914	37"	939	43 19.5	LS1236-36-3	LS1236-36-3L	LS1236	LS1236-L
12"	305	48"	1219	49"	1244	52 23.6	LS1248-36-3	LS1248-36-3L	LS1248	LS1248-L
12"	305	60"	1524	61"	1549	62 28.1	LS1260-36-3	LS1260-36-3L	LS1260	LS1260-L
12"	305	72"	1828	73"	1854	71 32.2	LS1272-36-3	LS1272-36-3L	LS1272	LS1272-L
15"	381	30"	762	31"	787	44 20.0	LS1530-36-3	LS1530-36-3L	LS1530	LS1530-L
15"	381	36"	914	37"	939	50 22.7	LS1536-36-3	LS1536-36-3L	LS1536	LS1536-L
15"	381	48"	1219	49"	1244	61 27.7	LS1548-36-3	LS1548-36-3L	LS1548	LS1548-L
15"	381	60"	1524	61"	1549	72 32.7	LS1560-36-3	LS1560-36-3L	LS1560	LS1560-L
15"	381	72"	1828	73"	1854	83 37.6	LS1572-36-3	LS1572-36-3L	LS1572	LS1572-L
18"	457	30"	762	31"	787	51 23.1	LS1830-36-3	LS1830-36-3L	LS1830	LS1830-L
18"	457	36"	914	37"	939	57 25.9	LS1836-36-3	LS1836-36-3L	LS1836	LS1836-L
18"	457	48"	1219	49"	1244	70 31.8	LS1848-36-3	LS1848-36-3L	LS1848	LS1848-L
18"	457	60"	1524	61"	1549	83 37.5	LS1860-36-3	LS1860-36-3L	LS1860	LS1860-L
18"	457	72"	1828	73"	1854	97 44.0	LS1872-36-3	LS1872-36-3L	LS1872	LS1872-L

Uprights
These uprights can be used between two shelves. Sold individually.

height		model #
in.	mm	
24"	457	LS24VU
18"	457	LS18VU
30"	457	LS30VU
36"	457	LS36VU
42"	457	LS42VU
48"	1219	LS48VU



**Download
Spec Sheet
EG03.80**

WITH DOWNTURNED BOOKENDS COMPONENTS

shelf depth		shelf length		overall length		weight lbs. kg	STANDARD SHELVES	WITH WIRE LEDGE	SINGLE SHELF	SINGLE SHELF WITH WIRE
in	mm	in	mm	in	mm		model #	model #	model #	model #
12"	305	30"	762	31"	787	38 17.2	LSD1230-36-3	LSD1230-36-3L	LSD1230	LSD1230-L
12"	305	36"	914	37"	939	43 19.5	LSD1236-36-3	LSD1236-36-3L	LSD1236	LSD1236-L
12"	305	48"	1219	49"	1244	52 23.6	LSD1248-36-3	LSD1248-36-3L	LSD1248	LSD1248-L
12"	305	60"	1524	61"	1549	62 28.1	LSD1260-36-3	LSD1260-36-3L	LSD1260	LSD1260-L
12"	305	72"	1828	73"	1854	71 32.2	LSD1272-36-3	LSD1272-36-3L	LSD1272	LSD1272-L
15"	381	30"	762	31"	787	44 20.0	LSD1530-36-3	LSD1530-36-3L	LSD1530	LSD1530-L
15"	381	36"	914	37"	939	50 22.7	LSD1536-36-3	LSD1536-36-3L	LSD1536	LSD1536-L
15"	381	48"	1219	49"	1244	61 27.7	LSD1548-36-3	LSD1548-36-3L	LSD1548	LSD1548-L
15"	381	60"	1524	61"	1549	72 32.7	LSD1560-36-3	LSD1560-36-3L	LSD1560	LSD1560-L
15"	381	72"	1828	73"	1854	83 37.6	LSD1572-36-3	LSD1572-36-3L	LSD1572	LSD1572-L
18"	457	30"	762	31"	787	51 23.1	LSD1830-36-3	LSD1830-36-3L	LSD1830	LSD1830-L
18"	457	36"	914	37"	939	57 25.9	LSD1836-36-3	LSD1836-36-3L	LSD1836	LSD1836-L
18"	457	48"	1219	49"	1244	70 31.8	LSD1848-36-3	LSD1848-36-3L	LSD1848	LSD1848-L
18"	457	60"	1524	61"	1549	83 37.5	LSD1860-36-3	LSD1860-36-3L	LSD1860	LSD1860-L
18"	457	72"	1828	73"	1854	97 44.0	LSD1872-36-3	LSD1872-36-3L	LSD1872	LSD1872-L

Uprights
These uprights can be used between two shelves. Sold individually.

height		model #
in.	mm	
18"	457	LS18VU
24"	457	LS24VU
30"	457	LS30VU
36"	457	LS36VU
42"	457	LS42VU
48"	1219	LS48VU

Peg Boards



SSC-PB1824-4



Download
Spec Sheet
EG03.60

FEATURES:

- Heavy gauge 304 stainless steel construction
- Comes standard with 6" white polymer pegs
- Choice of 2" or 4" integral drip trough
- All drip troughs come with 36" long clear flexible drain tubing
- Wall mounting bracket included

width		height		weight		no. of pegs	2" drip trough	4" drip trough
in	mm	in	mm	lbs.	kg		model #	model #
18"	457	24"	610	13	5.9	15	SSC-PB1824-2	SSC-PB1824-4
24"	610	18"	457	15	6.8	16	SSC-PB2418-2	SSC-PB2418-4
24"	610	24"	610	17	7.7	20	SSC-PB2424-2	SSC-PB2424-4
24"	610	30"	762	23	10.4	32	SSC-PB2430-2	SSC-PB2430-4
24"	610	36"	914	25	11.8	40	SSC-PB2436-2	SSC-PB2436-4
30"	762	24"	610	23	10.4	25	SSC-PB3024-2	SSC-PB3024-4
30"	762	30"	762	25	10.9	50	SSC-PB3030-2	SSC-PB3030-4
30"	762	36"	914	25	10.9	40	SSC-PB3036-2	SSC-PB3036-4
36"	914	24"	610	25	11.8	30	SSC-PB3624-2	SSC-PB3624-4
36"	914	30"	762	26	10.9	60	SSC-PB3630-2	SSC-PB3630-4
36"	914	36"	914	27	11.3	66	SSC-PB3636-2	SSC-PB3636-4
48"	1219	24"	610	26	11.8	40	SSC-PB4824-2	SSC-PB4824-4
48"	1219	30"	762	28	12.7	48	SSC-PB4830-2	SSC-PB4830-4
48"	1219	36"	914	30	13.6	88	SSC-PB4836-2	SSC-PB4836-4

Bench Frames

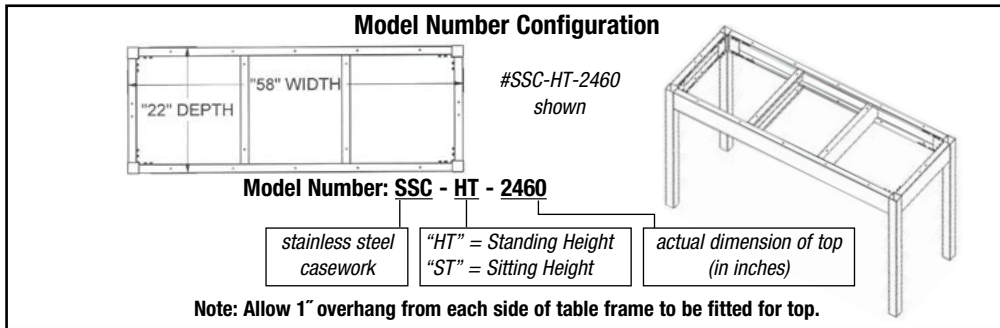

Standard Bench Frames

Download
Spec Sheet
EG03.50

FEATURES:

- Standing and Sitting-Height models available.
- 22" (559mm) or 28" (712mm) depth.

depth		width		weight		35" Standing Height		29 1/2" Sitting Height	
in	mm	in	mm	lbs.	kg	model #	weight	weight	model #
							lbs.	kg	
22"	559	22"	559	50	22.7	SSC-HT-2424	48	21.8	SSC-ST-2424
22"	559	28"	711	55	24.9	SSC-HT-2430	53	24.0	SSC-ST-2430
22"	559	34"	864	60	27.2	SSC-HT-2436	58	26.3	SSC-ST-2436
22"	559	40"	1016	65	29.5	SSC-HT-2442	63	28.6	SSC-ST-2442
22"	559	46"	1168	70	31.7	SSC-HT-2448	68	30.8	SSC-ST-2448
22"	559	58"	1473	78	35.4	SSC-HT-2460	76	34.5	SSC-ST-2460
22"	559	64"	1626	84	38.1	SSC-HT-2466	82	37.2	SSC-ST-2466
22"	559	70"	1778	90	40.8	SSC-HT-2472	88	39.9	SSC-ST-2472
28"	711	22"	559	55	24.9	SSC-HT-3024	53	24.0	SSC-ST-3024
28"	711	28"	711	58	26.3	SSC-HT-3030	56	25.4	SSC-ST-3030
28"	711	34"	864	65	29.5	SSC-HT-3036	63	28.6	SSC-ST-3036
28"	711	40"	1016	70	31.7	SSC-HT-3042	68	30.8	SSC-ST-3042
28"	711	46"	1168	75	34.0	SSC-HT-3048	73	33.1	SSC-ST-3048
28"	711	58"	1473	84	38.1	SSC-HT-3060	82	37.2	SSC-ST-3060
28"	711	64"	1626	91	41.3	SSC-HT-3066	89	40.4	SSC-ST-3066
28"	711	70"	1778	98	44.4	SSC-HT-3072	96	43.5	SSC-ST-3072

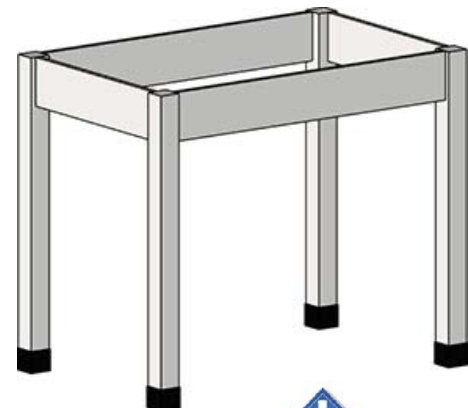

Adjustable Height Tables

Pinned Leg Adjustable Height Tables

FEATURES:

- 2" (51mm) square legs with leveling mount.
- Adjustable from 30" to 37" (762 to 940mm) height.
- 22" (559mm) or 28" (712mm) depth.

		Frame Assemblies Only		Units with Stainless* Steel Tabletop	
depth*		width*		model #	model #
in	mm	in	mm		
22"	559	22"	559	SSC-AHTP-2424	SSC-AHTTP-2424
22"	559	28"	711	SSC-AHTP-2430	SSC-AHTTP-2430
22"	559	34"	864	SSC-AHTP-2436	SSC-AHTTP-2436
22"	559	46"	1168	SSC-AHTP-2448	SSC-AHTTP-2448
22"	559	58"	1473	SSC-AHTP-2460	SSC-AHTTP-2460
22"	559	70"	1778	SSC-AHTP-2472	SSC-AHTTP-2472
28"	711	28"	711	SSC-AHTP-3030	SSC-AHTTP-3030
28"	711	34"	864	SSC-AHTP-3036	SSC-AHTTP-3036
28"	711	46"	1168	SSC-AHTP-3048	SSC-AHTTP-3048
28"	711	58"	1473	SSC-AHTP-3060	SSC-AHTTP-3060
28"	711	70"	1778	SSC-AHTP-3072	SSC-AHTTP-3072

* For units with tabletop, add 2" to width and depth. Tabletop is 16 gauge stainless steel, with support channels, sound-deadening tape, and square edge on all for sides.

Download
Spec Sheet
EG03.53



Electronic Drive Adjustable Height Tables

FEATURES:

- 2" (51mm) square legs with leveling mount.
- 29" to 40" (737 to 1016mm) height adjustment.
- Electromechanical drive in each leg.
- 22" (559mm) or 28" (712mm) depth.

		Frame Assemblies Only		Units with Stainless* Steel Tabletop	
depth*		width*		model #	model #
in	mm	in	mm		
22"	559	22"	559	SSC-AHTM-2424	SSC-AHTTM-2424
22"	559	28"	711	SSC-AHTM-2430	SSC-AHTTM-2430
22"	559	34"	864	SSC-AHTM-2436	SSC-AHTTM-2436
22"	559	46"	1168	SSC-AHTM-2448	SSC-AHTTM-2448
22"	559	58"	1473	SSC-AHTM-2460	SSC-AHTTM-2460
22"	559	70"	1778	SSC-AHTM-2472	SSC-AHTTM-2472
28"	711	28"	711	SSC-AHTM-3030	SSC-AHTTM-3030
28"	711	34"	864	SSC-AHTM-3036	SSC-AHTTM-3036
28"	711	46"	1168	SSC-AHTM-3048	SSC-AHTTM-3048
28"	711	58"	1473	SSC-AHTM-3060	SSC-AHTTM-3060
28"	711	70"	1778	SSC-AHTM-3072	SSC-AHTTM-3072

* For units with tabletop, add 2" to width and depth. Tabletop is 16 gauge stainless steel, with support channels, sound-deadening tape, and square edge on all for sides.

Download
Spec Sheet
EG03.54



Healthcare Storage Cabinets



double-width unit with baskets



single-width unit with baskets



Download
Spec Sheet
EG03.70

FEATURES:

- Type 304 stainless steel construction.
- 45 pairs of slides on inner panels.
- Hinged doors, with 4" (102mm) wire-style pulls, available solid or with framed glass.
- Single- and double-width units available.
- 83" (2108mm) height.

Single-Width Units

Double-Width Units

depth			width			width		
in.	mm	description	in.	mm	model #	in.	mm	model #
18"	457	solid	28"	711	PSSC-TCB-1828	54"	1372	PSSC-TCB-1854
18"	457	with framed glass	28"	711	PSSC-TCBG-1828	54"	1372	PSSC-TCBG-1854
26"	661	solid	20"	508	PSSC-TCB-2620	38"	965	PSSC-TCB-2638
26"	661	with framed glass	20"	508	PSSC-TCBG-2620	38"	965	PSSC-TCBG-2638



Baskets and Trays for Healthcare Storage Cabinets

FEATURES:

- Cream-colored ABS material.
- Tray stopper keeps basket / tray from falling.
- 23 $\frac{3}{8}$ " x 15 $\frac{3}{4}$ " (600 x 400mm).



#PSST-SB4

Baskets and Trays

height		length x width		OPEN BASKETS	SOLID TRAYS	Optional Dividers	
in.	mm	in.	mm	model #	model #	SHORT model #	LONG model #
2"	51	23 $\frac{3}{8}$ "	15 $\frac{3}{4}$ "	-	PSSC-ST2	PSSC-SD2	PSSC-LD2
4"	102	23 $\frac{3}{8}$ "	15 $\frac{3}{4}$ "	PSSC-SB4	PSSC-ST4	PSSC-SD4	PSSC-LD4
8"	203	23 $\frac{3}{8}$ "	15 $\frac{3}{4}$ "	PSSC-SB8	PSSC-ST8	PSSC-SD8	PSSC-LD



#PSST-ST8
shown with dividers

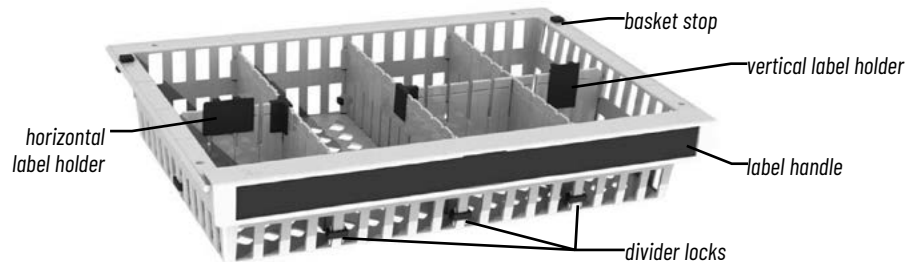

Download
Spec Sheet
EG03.71

Accessories for Baskets and Trays

description	model #
vertical label holder: can be adhered to top of dividers or front edge of baskets	PSSC-LHV
horizontal label holder: can be adhered to top of dividers or front edge of baskets	PSSC-LHH
label handle: color-coded, over 20 colors available	PSSC-LHAN
T-holder for dividers: allows use of custom-length dividers	PSSC-THD
basket stop: prevents basket from falling out when pulled	PSSC-BSKSTP
divider lock: keeps dividers locked in place	PSSC-DL

Stainless Steel Countertops



stainless steel countertops fabricated to drawings indicating backsplash height, raised edge and field condition requirements

- 14 or 16 gauge, type 304 or 316 stainless steel. Other gauges and types of stainless available to meet the function and chemical resistant demands of highly specialized labs.
- Standard front edge Square or Box Marine, unless otherwise specified. See detail 1 on next page.
- Back and end splashes are manufactured per specification. See details 2 & 3 on next page. All working surfaces and sink bowls have coved sanitary horizontal and vertical corners.
- Either a mechanical hairline seam or field welded joint available per your specifications. Maximum length without seam is 144" if no end splash. Length is reduced by 5½" for each end splash that may be required.
- Fabricated sink bowls available in most any size and depth with single or multiple compartments.
- For backsplash mounted faucets, splash will need to be at least 2" deep for plumbing access, holes for deck mounted faucets are typically centered 1½" from the edge of sink bowl.
- Both L-shaped and U-shaped tops are available per your drawings.
 - Corners are mitered and factory welded.
 - Maximum size without field joint provisions is 96" x 96" to fit into standard trailer for ground shipment.
- Countertops have stainless steel reinforcing hat channels. National Sanitation Foundation (NSF)-listed sprayed latex sound deadening available upon request.
- Standard packaging is wood crated and is included in the cost.

**Download
Spec Sheet
EG04.12**



Stainless Steel Countertops

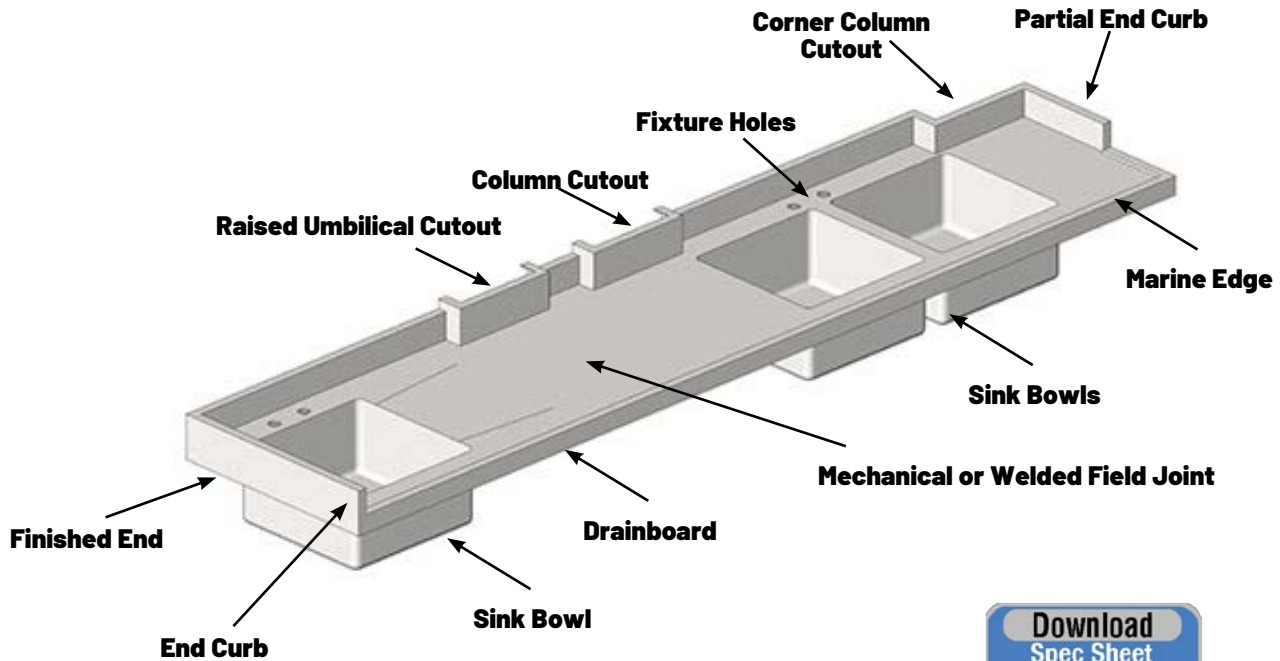

[Download Spec Sheet EG04.12](#)

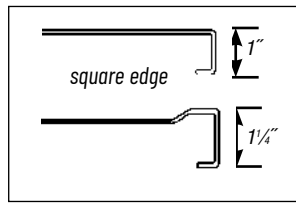
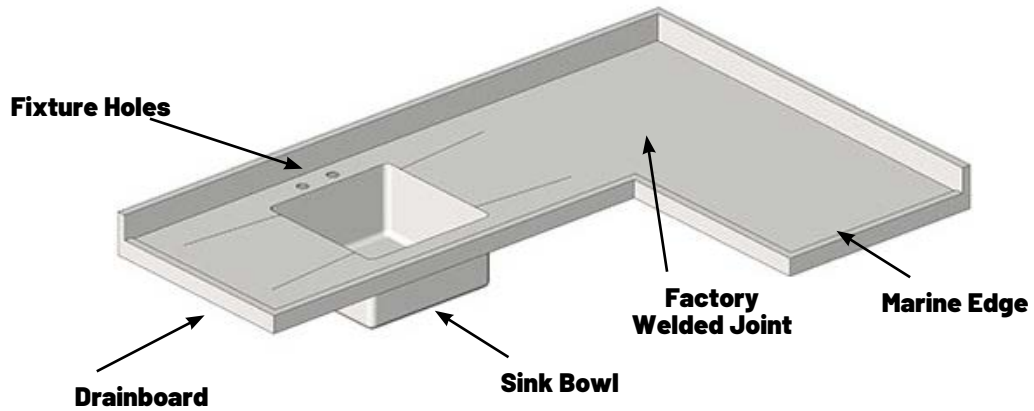

box marine edge

detail 1: edges

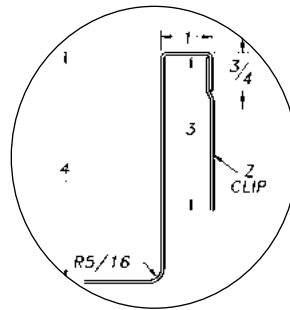

detail 2:

4" backsplash with 1" return and turndown.

- NOTE:
- Drawings to be submitted for approval prior to fabrication using the latest version of AutoCad software. They will be emailed in Adobe Acrobat format (.pdf) unless specified otherwise. AutoCad files (.dwg) are available upon request.
 - Complete field welding and finishing services are available at additional expense.

Eagle MHC offers a variety of products to serve the needs of the Cleanroom and Lab marketplace. Products include gowning racks and benches, stationary and mobile workstations, cleanroom tables, stainless steel countertops, a variety of transport and storage carts and shelving, and a full line of stainless steel lab sinks, including stand alone and drop in models. Our equipment is engineered to meet "good-better-best" class requirements in critical environments. Custom options are also available to meet your specific requirements.

Eagle MHC is represented across the country by independent representatives that are available to assist you and make the process of doing business with Eagle easy. They are supported by a customer service team that can assist with quotes, order status, freight estimates, and answer any questions that you may have.



Cleanroom/Lab Products



Eagle MHC's experienced Design and Quotations Team can work with you to ensure your project meets and exceeds your laboratory requirements.

We support you every step of the process, from quotations, layout, submittals and through our state of the art manufacturing processes.

Our professional Field Services Team can assist with installation, field work and on site management of the installation process.

To Request A Quotation, contact our Quotations Team via email at quotes@eaglegrp.com

The Eagle Advantage™ begins right here in our state of the art manufacturing facility - with 14 acres under one roof - where the most comprehensive broadline product offering in the industry takes shape. This all-inclusive design and production capability offers distinct advantages to our customers. Streamlined ordering and shipping substantially reduce freight, receiving, installation and administrative costs.

Supporting it all is a framework of highly responsive customer service representatives, the most innovative, versatile and durable equipment available on the market today, a fleet of company-owned trucks, plus amply stocked distribution centers in strategic locations nationwide - which guarantees product availability and delivery. Together, it adds up to product excellence enhanced by measurable cost savings and value. We call it The Eagle Advantage™ and you can profit from it.



©2024 Eagle MHC

Although every attempt has been made to ensure the accuracy of the data in this publication, we cannot be responsible for printing or typographical errors or omissions.



100 Industrial Blvd. Clayton DE, 19938
P: (800) 441-8440 • F: (302) 653-2065
www.eaglemhc.com



Rev 08/2024 EG7024